

Name: Clinipak RELIANCE® CREPE GREEN/WHITE

Product Code(s):

- RELIANCE® CREPE WHITE (WHCREPExxxx)
- RELIANCE® CREPE GREEN (GRNCREPExxxx)

(Where xxxx= sheet size)

Name of Manufacturer:



Distributed by Key Surgical Ltd

Intended Use

Clinipak RELIANCE® CREPE is a single use sterilisation wrap that is used to help to prevent microorganisms (bacteria, viruses, spores) from easily gaining access to the tray contents, allow sterilisation, provide physical protection, maintain sterility up to the point of use, and allow aseptic presentation.

The crepe wrap is used in combination with a second sterilisation wrap; this sterilisation wrap can be another sheet of crepe wrap or a different type of sterilisation wrap such as a non-woven type.

Clinipak RELIANCE® CREPE is intended to be used by professional healthcare personnel working in sterile services (or similar) departments.

Single Use

Clinipak RELIANCE® CREPE is single use only and must not be re-used.

Sterilisation Compatibility

Clinipak RELIANCE® CREPE is compatible with the following sterilisation methods:

- Steam (up to 135°C)
- Ethylene Oxide (EtO)
- Formaldehyde
- Gamma Irradiation (Co 60 - 50 kGy)

Storage Conditions

It is recommended that Clinipak RELIANCE® CREPE is stored in a cool, dry place, out of direct sunlight.

Location of use should be clean, dust-free, dry, and away from fluorescent or ultraviolet light sources.

Allow wrapping material to condition to atmospheric temperature and humidity prior to use.

Precautions

Do not use sheet if damaged or extraneous matter is detected.

Do not use with sharp instruments. These may damage the wrap and compromise barrier properties.

Wrapping with crepe sterilisation paper

- 1) Clinipak RELIANCE® CREPE can be used in the same way as any other standard tray wrap.
- 2) Crepe sterilisation wrap should always be used in combination with at least one other tray wrap. When used with a non-woven or SMS-type tray wrap, the crepe sterilisation wrap should be used as the inner wrap.
- 3) Any of the tray wrapping techniques can be used in either a sequential or a simultaneous wrapping procedure.

Below are examples of two well-known wrapping techniques - Envelope fold and Parcel Fold

Envelope fold method:

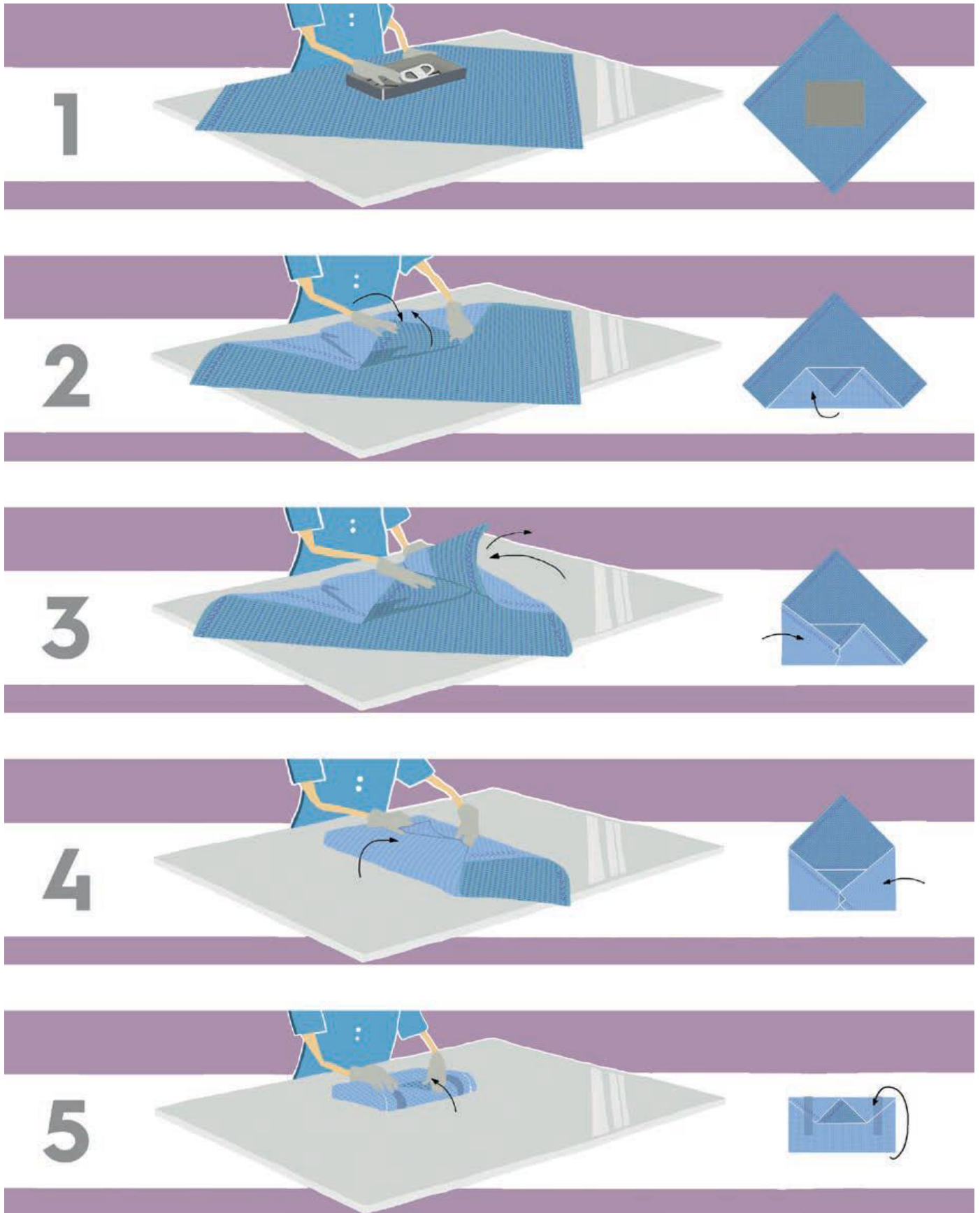

Parcel fold method:

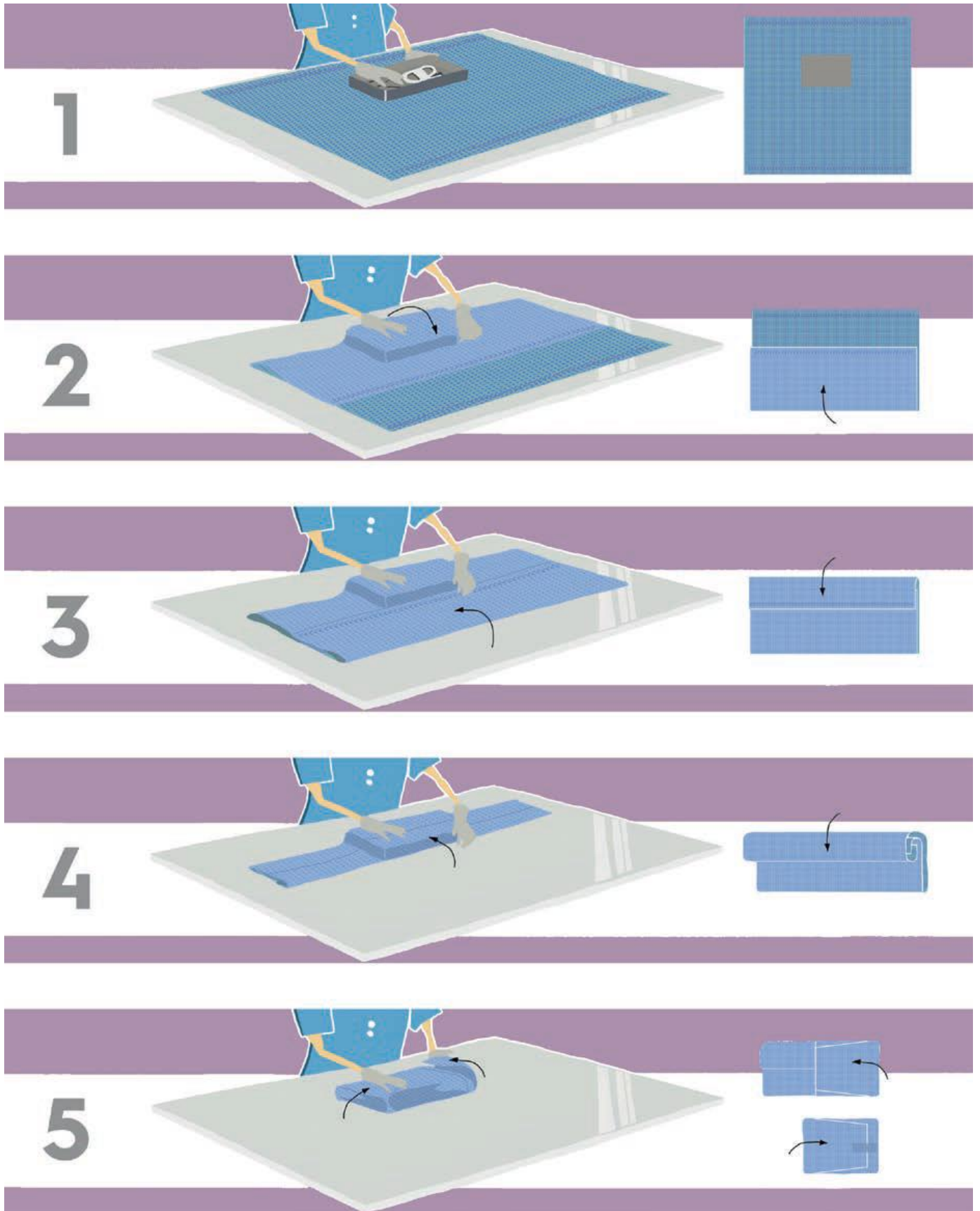

Securing the Wrapped Package

Secure the wrapped package with an appropriate tape suitable for the sterilisation method chosen and label.

The closure must allow the sterilisation method to penetrate the wrapped package to sterilise the contents of the package.

Avoid constricting the wrapped package and maintain the package integrity.

Post-Sterilisation Cooling and Opening

Leave wrapped packages on the steriliser cart until cool to avoid compromising the package sterility.

Do not stack wrapped trays as this can result in damage to the wrap caused by undue pressure from the weight.

Inspect the package for damage, wetness, or any sign of potential contamination prior to opening and again after opening (before the use of the contents). Do not use contents if these conditions are present as sterility could be compromised.

If these conditions are noticed, reprocess the content using unprocessed wrap.

Disposal

Unused Clinipak RELIANCE® CREPE may be disposed of in the same way that the user normally disposes of paper. It is suitable for recycling in the waste paper stream.

Used Clinipak RELIANCE® CREPE should be disposed of by considering possible microbial contamination. The user should reference their own procedures in this matter based upon local regulations.

Suitable for incineration. Product is not biodegradable.